

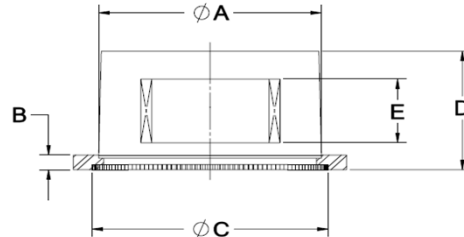

SELF-CLINCHING, NON-ALIGNING PTFE IMPREGNATED BRONZE BEARINGS



Spyraflo's self-clinching bearings are the economic solution when mounting PTFE Impregnated Bronze bearings into steel paneling. Removing the need for bearing mounting blocks the Spyraflo solution simply uses self-clinching technology to securely retain and size the bearing in place directly into the panel material.

PTFE Impregnated Bronze Bearings are an economic solution for high load / medium speed applications; impervious to dirt and dust.

- Flange-Mount option.
- Electrically conductive.
- The steel retainer absorbs the installation forces with zero effect on the bearing ID.
- Suitable for rotational and oscillatory motion.
- Installation equally successful on thin sheet steel or thick panels.

Refer to the Installation section on www.spyraflo.com for installation instructions.

Part Number	Shaft Dia. Min. Max.	Max. Load lbf/N	Max. Speed r.p.m.	Mounting Hole A	Min. Panel Thickness B	Min. CL to Edge	C	D	E	Weight oz/g
FSPN-187	0.1858 - 0.1865	360	8,040	0.375	0.040	0.25	0.42	0.29	0.19	0.4
FSPN-250	0.2481 - 0.2490	430	6,020	0.500	0.040	0.37	0.55	0.36	0.25	0.3
FSPN-312	0.3106 - 0.3115	430	4,820	0.500	0.040	0.37	0.55	0.50	0.37	0.2
FSPN-375	0.3731 - 0.3740	600	4,010	0.625	0.060	0.45	0.67	0.48	0.37	0.4
FSPN-500	0.4980 - 0.4990	950	3,010	0.812	0.060	0.50	0.87	0.49	0.37	0.7
FSPN-625	0.6230 - 0.6240	1,150	2,410	0.875	0.060	0.63	0.92	0.62	0.50	0.7
FSPN-750	0.7479 - 0.7491	1,150	2,010	1.063	0.075	0.75	1.10	0.62	0.50	1.3
FSPN-4M	3.992 - 4.000	1,530	9,540	9.50	1.0	6.4	10.5	6.7	4.0	11
FSPN-6M	5.978 - 5.990	1,780	6,360	12.70	1.0	9.5	14.0	8.7	6.0	9
FSPN-8M	7.972 - 7.987	1,780	4,770	15.90	1.5	11.5	17.0	10.7	8.0	10
FSPN-10M	9.972 - 9.987	2,550	3,820	15.90	1.5	11.5	17.0	12.9	10.0	11
FSPN-12M	11.966 - 11.984	2,550	2,180	20.60	1.5	12.7	22.0	12.9	10.0	21
FSPN-16M	15.966 - 15.984	4,800	2,390	22.20	1.5	16.0	23.0	14.9	10.0	20
FSPN-18M	17.966 - 17.984	4,800	2,120	27.00	2.0	19.0	28.0	17.9	15.0	41

For more information about Spyraflo bearings visit www.spyraflo.com.